

"MVX"



Sealand Electric Pumps South Africa

44 Agaat Str, Nirvana Industrial, Polokwane, Limpopo Province, South Africa, 0699



+27 87 150 2772



+27 86 647 3047



info@sealand.co.za



www.sealand.co.za

VERTICAL CENTRIFUGAL MULTISTAGE ELECTRIC PUMPS IN STAINLESS STEEL

Extremely noiseless and reliable the vertical centrifugal multistage electric pumps of the series MXV have been designed to pump clean liquids, without abrasives and suspended solids, non-explosive or aggressive for the pump's materials

- Liquid temperature not higher than 35 °C for domestic use (CEI EN 60335-2-41) or 120 °C for other use, while the ambient temperature must not be higher than 40 °C
- Maximum working pressure is 27 bar
- Flow rate up to ~ 25 m³/h
- Heads up to ~ 250 m

TECHNICAL FEATURES

- Motor bracket: cast iron G20 with anti-corrosive coating
- Diffusers: stainless steel Aisi 304
- Pump body: in precision-cast stainless steel Aisi 304
- Impellers: stainless steel Aisi 304
- Pump shaft: stainless steel Aisi 304
- Bushings: Tungsten carbide
- Mechanical seal: carbon-ceramics

MOTOR

The control motors are asynchronous, squirrel cage-type, closed, with external ventilation

- Incorporated motor protection and capacitor always on, for single-phase models
- The motor protection for three-phase models must be installed by the customer. Equipment compliant with current standards should be used
- Class of insulation: F-service: S1-Degree of protection: IP 44
- Terminal board protection: IP 54



Heart of steel

SPARE PARTS LIST

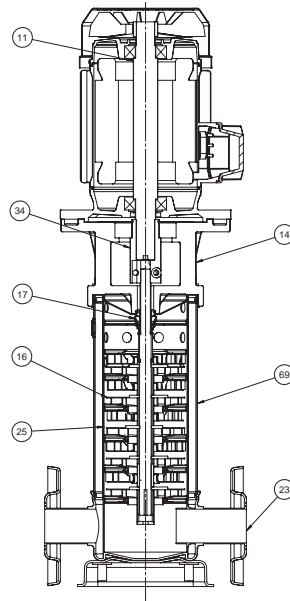

- 11 Pump shaft + rotor
- 14 Outlet bracket
- 16 Impeller
- 17 Mechanical seal
- 34 Coupling
- 23 Suction flange body
- 25 Diffuser
- 69 Cover

50 Hz - min ~ 2900

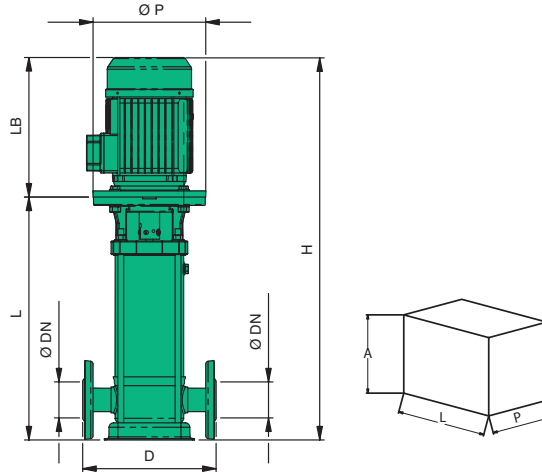

TYPE	HYDRAULIC DIMENSIONS [mm]			MOTOR [mm]			PACKING [mm]			WEIGHT [kg]
	D	L	DN	LB	ØP	H	A	L	P	
MXV 3-6 FT	250	425	25	232	B14	657	737	310	310	29
MXV 3-7 FT	250	449	25	232	B14	681	761	310	310	29,5
MXV 3-8 FT	250	483	25	267	B14	750	830	310	310	33
MXV 3-10 FT	250	531	25	267	B14	798	878	310	310	34,5
MXV 3-12 FT	250	579	25	267	B14	846	926	310	310	37,5
MXV 3-14 FT	250	627	25	267	B14	894	974	310	310	39
MXV 3-17 F	250	709	25	306	B14	1015	1095	310	310	48
MXV 3-20 F	250	781	25	328	B14	1109	1189	310	310	60,5
MXV 3-22 F	250	829	25	328	B14	1157	1237	310	310	62
MXV 5-5 FT	250	400,5	32	232	B14	632,5	712,5	310	310	285
MXV 5-7 FT	250	459	32	267	B14	726	806	310	310	33
MXV 5-8 FT	250	483	32	267	B14	750	830	310	310	35,5
MXV 5-10 FT	250	531	32	267	B14	798	878	310	310	36,5
MXV 5-12 FT	250	589	32	306	B14	895	975	310	310	45,5
MXV 5-14 FT	250	637	32	306	B14	943	1023	310	310	47
MXV 5-17 FT	250	709	32	328	B14	1037	1117	310	310	59
MXV 5-19 FT	250	779,5	32	362	B5	1141,5	1221,5	310	310	78
MXV 5-22 FT	250	851,5	32	362	B5	1213,5	1293,5	310	310	79,5
MXV 9-5 FT	280	448	40	267	B14	715	795	310	310	36
MXV 9-6 FT	280	478	40	267	B14	745	825	310	310	37
MXV 9-7 FT	280	518	40	306	B14	824	904	310	310	45
MXV 9-8 FT	280	548	40	306	B14	854	934	310	310	34
MXV 9-10 FT	280	608	40	328	B14	936	1016	310	310	58
MXV 9-12 FT	280	690,5	40	362	B5	1052,5	1132,5	310	310	76,5
MXV 9-14 FT	280	750,5	40	362	B5	1112,5	1192,5	310	310	78
MXV 9-17 FT	280	840,5	40	362	B5	1202,5	1282,5	310	310	87,5
MXV 9-20 FT	280	930,5	40	362	B5	1292,5	1372,5	310	310	89,5
MXV 16-4 FT	300	467,5	50	306	B14	773,5	853,5	310	310	44,5
MXV 16-5 FT	300	505	50	328	B14	833	913	310	310	56
MXV 16-6 FT	300	565	50	362	B5	927	1007	310	310	74,5
MXV 16-7 FT	300	602,5	50	362	B5	964,5	1044,5	310	310	75,5
MXV 16-8 FT	300	640	50	362	B5	1002	1082	310	310	76,5
MXV 16-9 FT	300	677,5	50	362	B5	1039,5	1119,5	310	310	84,5
MXV 16-10 FT	300	715,5	50	362	B5	1077,5	1157,5	310	310	85,5
MXV 16-11 FT	300	753	50	362	B5	1115	1195	310	310	86,5
MXV 16-12 FT	300	790,5	50	420	B5	1210,5	1290,5	310	310	87,5
MXV 16-13 FT	300	828	50	420	B5	1248	1328	310	310	88
MXV 16-14 FT	300	865,5	50	420	B5	1285,5	1365,5	310	310	89
MXV 16-15 FT	300	903	50	420	B5	1323	1403	310	310	90
MXV 16-16 FT	300	940,5	50	420	B5	1360,5	1440,5	310	310	91

min⁻¹ ~ 2900

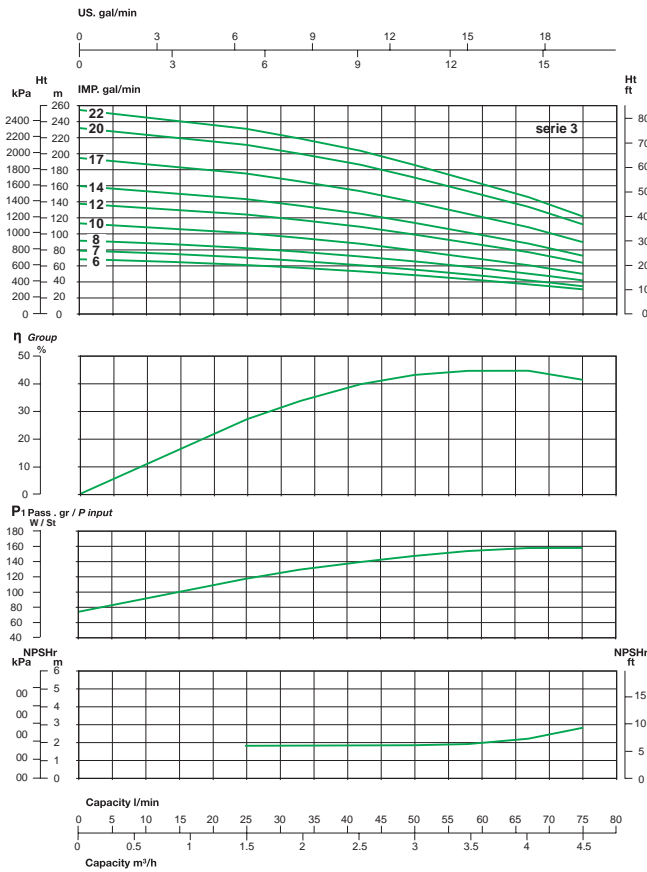

min⁻¹ ~ 2900

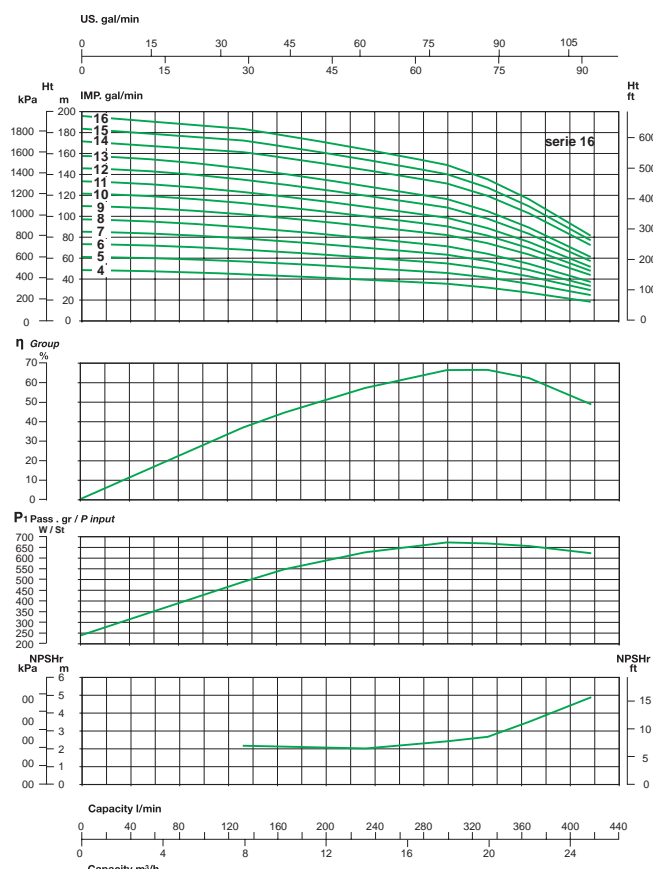
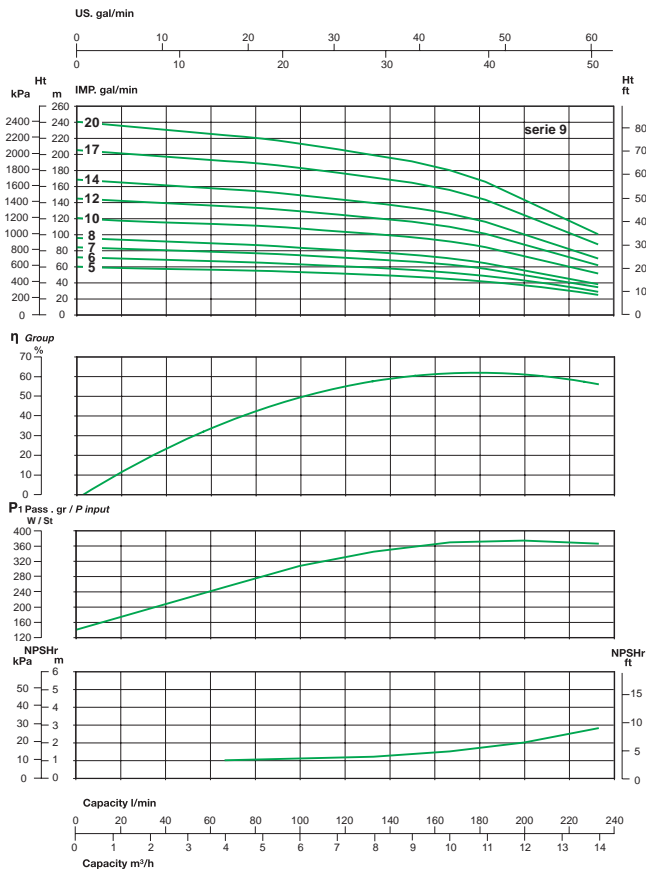
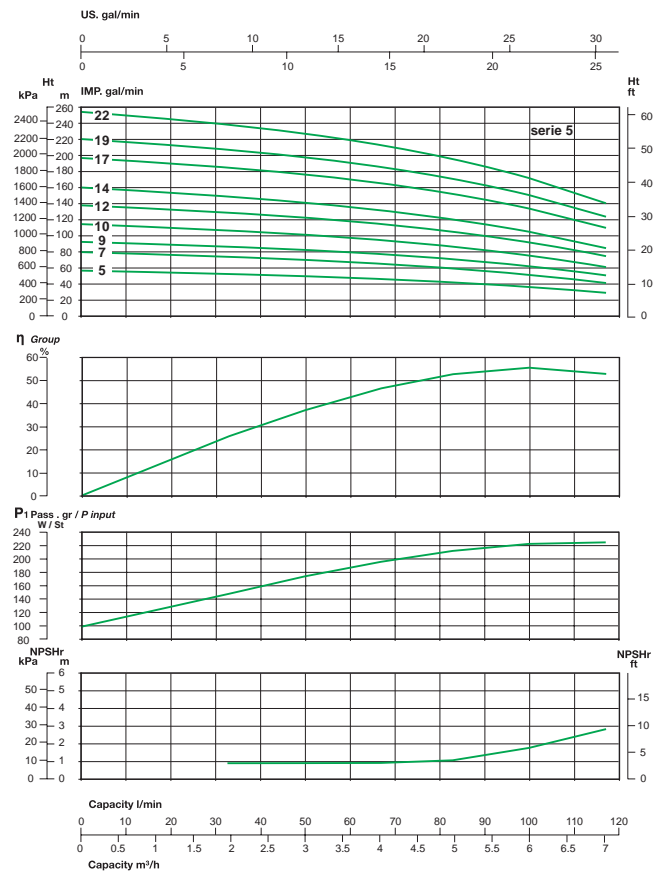

Sealand Electric Pumps South Africa

44 Agaat Str, Nirvana Industrial, Polokwane, Limpopo Province, South Africa, 0699



+27 87 150 2772



+27 86 647 3047



info@sealand.co.za



www.sealand.co.za