

"JEXI"



Electric pumps

Sealand Electric Pumps South Africa

44 Agaat Str, Nirvana Industrial, Polokwane, Limpopo Province, South Africa, 0699

+27 87 150 2772 +27 86 647 3047 info@sealand.co.za www.sealand.co.za

STAINLESS STEEL SELF-PRIMING ELECTRIC PUMPS

The self-priming centrifugal electric pumps series JEXI have been designed to pump clean water from wells, even if mixed with gas

- Maximum suction up to 8-9 m
- Liquid temperature not higher than 35 °C for domestic use (CEI EN 60335-2-41) or 60 °C for other use, while the ambient temperature must not be higher than 40 °C
- Flow rate up to ~ 4 m³/h
- Heads up to ~ 50 m

TECHNICAL FEATURES

- Pump body: stainless steel Aisi 304
- Motor bracket in die casting aluminium UNI 5076
- Diffuser, Nozzle & Venturi tube: Techno-polymer
- Impeller: stainless steel Aisi 304 (Techno-polymer JEXI 65-85-105)
- Pump shaft: stainless steel Aisi 304 (Aisi 420F JEXI 65-85-105)
- Mechanical seal: carbon-ceramics

MOTOR

The control motors are asynchronous, squirrel cage-type, closed, with external ventilation

- Incorporated motor protection and capacitor always on, for single-phase models
- The motor protection for three-phase models must be installed by the customer. Equipment compliant with current standards should be used
- Class of insulation: F-service: S1-Degree of protection: IP 44
- Terminal board protection: IP 54

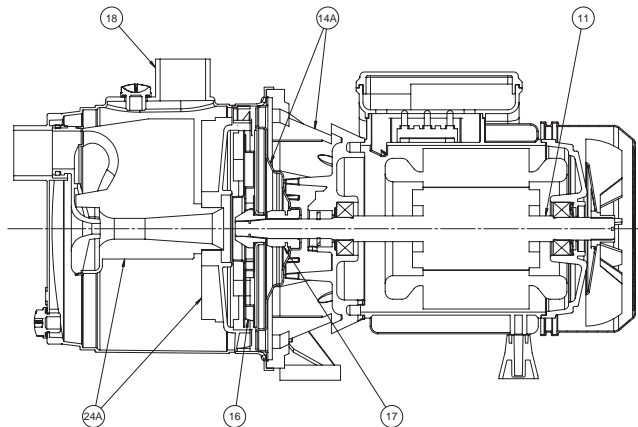

SPARE PARTS LIST

- 11 Pump shaft + rotor
- 14A Motor bracket kit
- 16 Impeller
- 17 Mechanical seal
- 18 Pump body
- 24A Diffuser, Nozze & Venturi

50 Hz - min⁻¹ ~ 2900

TYPE		Nominal power		Input power [W]		Capacitor 450 V max	Input current [A]			Capacity							
Single-phase	Three-phase	kW	HP	a	b	[μF]	1~230V	3~230V	3~400V	Q [m ³ /h]	0	0,6	1,2	1,8	2,4	3	3,6
a	b									Q [l/1']	0	10	20	30	40	50	60
JEXI 65 M	JEXI 65 T	0,44	0,6	700	680	12,5	3,1	2,4	1,4	H [m]	36,1	29,0	23,3	19,0	16,1		
JEXI 85 M	-	0,59	0,8	900	-	14	4,3	-	-		47,2	39,8	33,4	27,8	15,3		
JEXI 105 M	JEXI 105 T	0,74	1	1020	1250	20	4,6	3,6	2,3		48,1	43,0	35,0	30,2	25,0	10	
JEXI 101 M	JEXI 101 T	0,74	1	920	930	16	4,3	3,6	2,3		46,2	39,1	33,0	27,9	23,9	20,9	18,9
JEXI 121 M	JEXI 121 T	0,88	1,2	1110	1040	20	6,3	4,7	2,7		51,3	45,9	41,4	36,4	31,8	27,3	23,0

a) ~ Single-phase 230 V

b) ~ Three-phase 230/400 V

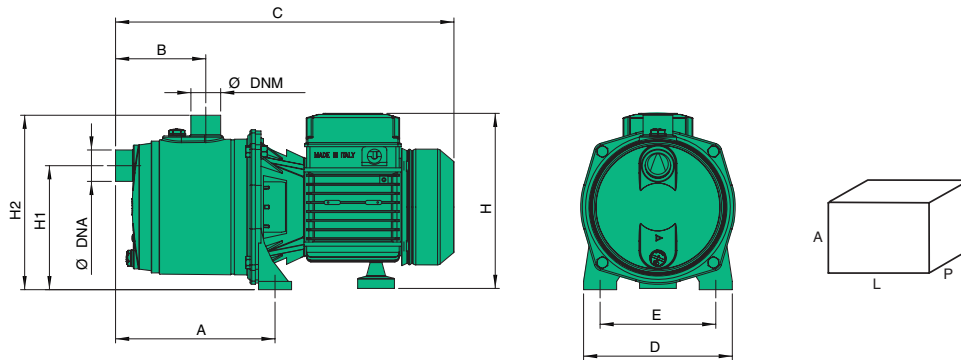

TIPO TYPE	DIMENSIONS [mm]										PACKING [mm]			WEIGHT [kg]
	A	B	C	D	E	H	H1	H2	DNA	DNM	A	L	P	
JEXI 65	180	95	370	180	140	194	155	200	1"	1"	250	450	190	7,6
JEXI 85	180	95	390	180	140	204	155	200	1"	1"	250	450	190	9
JEXI 105	180	95	390	180	140	204	155	200	1"	1"	250	450	190	9,6
JEXI 101	210	118	428	180	140	204	155	200	1"	1"	250	440	210	10,8
JEXI 121	210	118	428	180	140	204	155	200	1"	1"	250	440	210	11,5

min⁻¹ ~ 2900

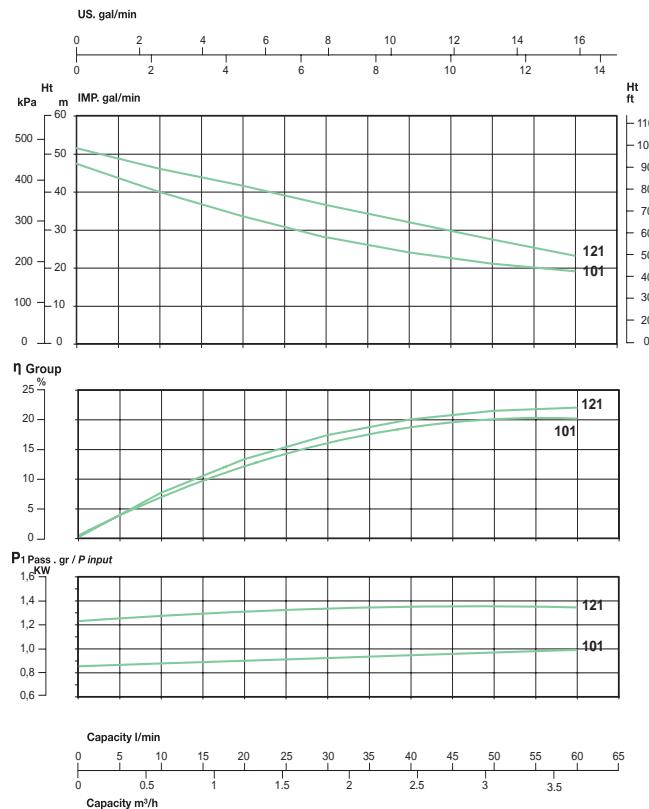
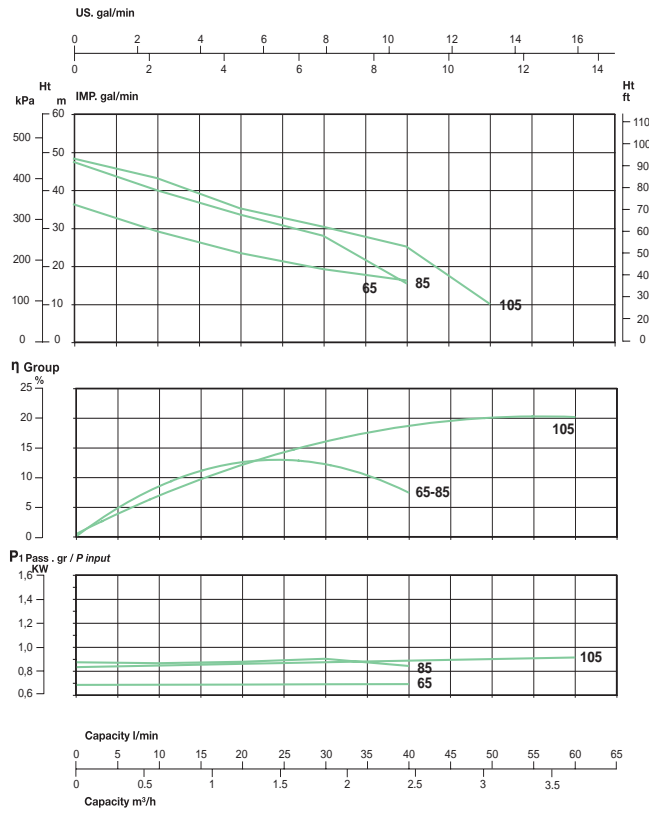

Sealand Electric Pumps South Africa

44 Agaat Str, Nirvana Industrial, Polokwane, Limpopo Province, South Africa, 0699



+27 87 150 2772



+27 86 647 3047



info@sealand.co.za



www.sealand.co.za