

“DVJ”



Sealand Electric Pumps South Africa

44 Agaat Str, Nirvana Industrial, Polokwane, Limpopo Province, South Africa, 0699



+27 87 150 2772



+27 86 647 3047



info@sealand.co.za



www.sealand.co.za

SUBMERSIBLE ELECTRIC WASTEWATER PUMPS

The submersible draining electric pump with vortex impeller series DVJ have been designed for pumping dirty liquids, non-explosive or chemically aggressive for the pump's materials, either containing suspended solids max Ø 40 mm. Temperatures not higher 35 °C (CEI EN 60335-2-41).

TECHNICAL FEATURES

- Motor body: stainless steel Aisi 304
- Pump body: cast iron G20 with anti-corrosive coating
- Impeller: cast iron G20 with anti-corrosive coating
- Pump shaft: stainless steel Aisi 420
- Pump's side mechanical seal: carbon - ceramics
- Motor's side seal: lip ring in NBR
- Feeding cable: 10 m H07RN-F

MOTOR

- Two poles induction rewindable motor with protection IP 68, class F insulation.
- Single-phase feeding with incorporated motor protector and capacitor permanently connected.
- Three-phase feeding with compulsory protection to be provided by the user.
- Continuous duty if completely submerged.

ON REQUEST:

- Single-phase automatic version with float switch (AUT).
- Brass hose connector Ø 50 mm.

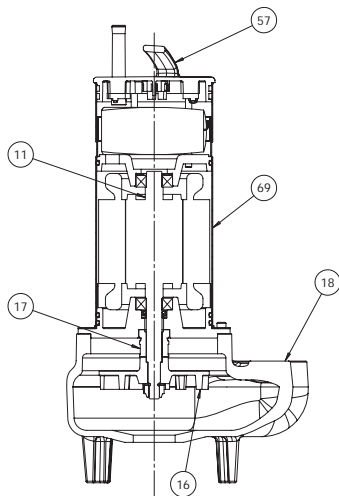

SPARE PARTS LIST

- 11 Pump shaft + rotor
- 16 Impeller
- 17 Mechanical seal
- 18 Pump body
- 57 Handle
- 69 Cover

$\text{min}^{-1} \sim 2900$

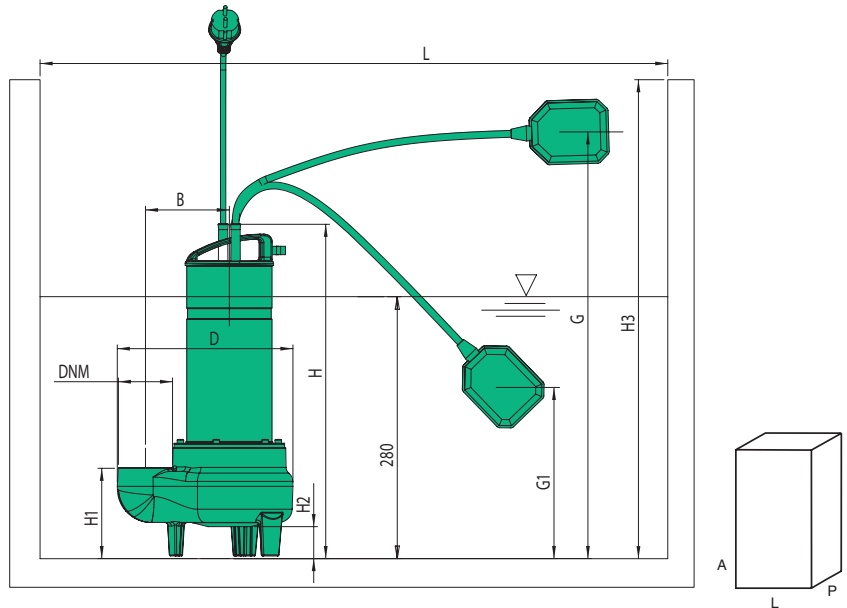
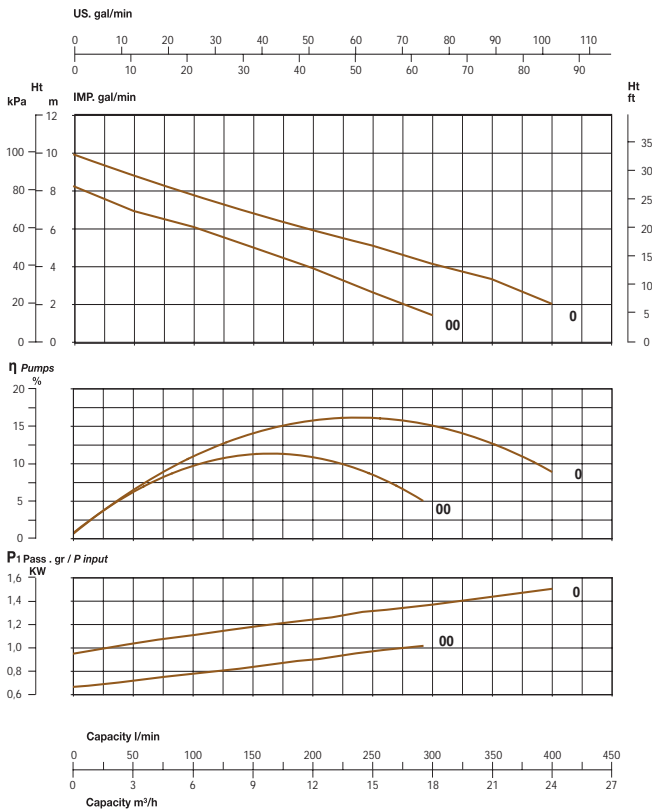

TYPE	DIMENSIONS [mm]											PACKING [mm]			WEIGHT [kg]
	H	H1	H2	H3	B	D	F	G	G1	L	DNM	A	L	P	
DVJ 100	440	120	40	850	120	230	40			600X600	2"	290	610	250	14.8
DVJ 100 AUT	440	120	40	850	120	230	40	700	200	600X600	2"	290	610	250	15,2
DVJ 120	440	120	40	850	120	230	40			600X600	2"	290	610	250	16
DVJ 120 AUT	440	120	40	850	120	230	40	700	200	600X600	2"	290	610	250	16.4

50 Hz

TYPE	Nominal power	Input power [W]	Capacitor 450 V max	Input current [A]	Capacity													
					Q [m³/h]	Q [l/1']	Total head (m W.C.)											
Single-phase	Three-phase	kW	HP	a	b	[µF]	1~230V	3~400V	H [m]									
DVJ 100 M	DVJ 100 T	0,74	1	980	1000	20	4,6	1,9	8,2	6,9	6,0	5,0	3,9	2,6	1,4			
DVJ 120 M	DVJ 120 T	0,89	1,2	1500	1510	25	6,8	2,9	9,9	8,8	7,7	6,8	5,9	5,1	4,1	3,3	2,0	

a) ~ Single-phase 230 V

b) ~ Three-phase 400 V

Sealand Electric Pumps South Africa

44 Agaat Str, Nirvana Industrial, Polokwane, Limpopo Province, South Africa, 0699



+27 87 150 2772



+27 86 647 3047



info@sealand.co.za



www.sealand.co.za