

"BK"



Sealand Electric Pumps South Africa

44 Agaat Str, Nirvana Industrial, Polokwane, Limpopo Province, South Africa, 0699



+27 87 150 2772



+27 86 647 3047



info@sealand.co.za



www.sealand.co.za

TWIN IMPELLER CENTRIFUGAL ELECTRIC PUMPS

The close-coupled electric pumps with back to back impellers (with an axial balanced thrust) series BK have been designed to pump from basins or storage tanks, clean liquids, without abrasives and suspended solids, non-explosive or aggressive for the pump's materials

- Liquid temperature not higher than 35 °C for domestic use (CEI EN 60335-2-41) or 90 °C for other use, while the ambient temperature must not be higher than 40 °C
- Flow rate up to ~ 30 m³/h
- Heads up to ~ 110 m

TECHNICAL FEATURES

- Pump body: cast iron G20 with anti-corrosive coating
- Suction flange: cast iron G20 with anti-corrosive coating
- Middle flange: cast iron G20 with anti-corrosive coating
- Impellers: stamped brass UNI- EN 12165 for the BK series
- Impellers: G20 cast iron for the BK 753/1503
- Pump shaft: stainless steel Aisi 304 (Aisi 420 F for BK 100)
- Mechanical seal: carbon-ceramics

MOTOR

The control motors are asynchronous, squirrel cage-type, closed, with external ventilation

- Incorporated motor protection and capacitor always on, for single-phase models
- The motor protection for three-phase models must be installed by the customer. Equipment compliant with current standards should be used
- Class of insulation:F-service:S1-Degree of protection: IP 44
- Terminal board protection: IP 54

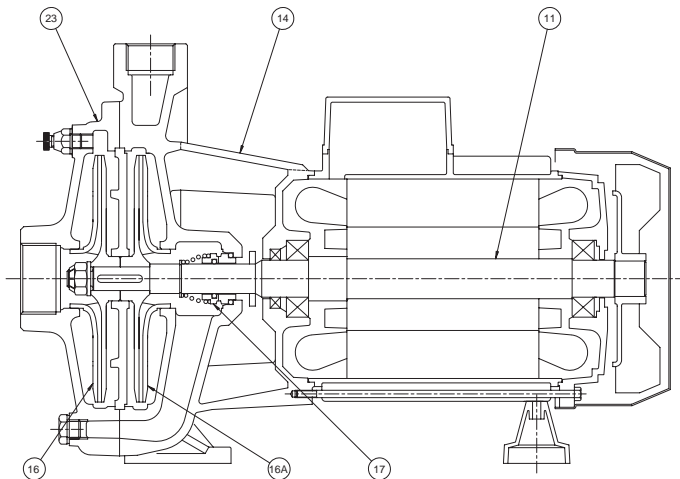

SPARE PARTS LIST

- 11 Pump shaft + rotor
- 14 Outlet bracket
- 16 Impeller
- 16A Impeller back
- 17 Mechanical seal
- 23 Suction flange body

50 Hz - min⁻¹ ~ 2900

TYPE		Nominal power		Input power [W]		Capacitor 450 V max	Input current [A]			Capacity								
Single-phase	Three-phase	kW	HP	a	b		[μF]	1~230V	3~230V	3~400V	Q [m ³ /h]	Q [l/s]	Total head (m W.C.)					
a	b																	
BK 100 M	BK 100 T	0,75	1	1250	1140	18	5,5	4	2,3	H [m]	43,5	42,0	39,5	35,0	29,0	20,5	13	

a) ~ Single-phase 230 V

b) ~ Three-phase 230/400 V

TYPE		Nominal power		Input power [W]		Capacitor 450 V max	Input current [A]			Capacity								
Single-phase	Three-phase	kW	HP	a	b		[μF]	1~230V	3~230V	3~400V	Q [m ³ /h]	Q [l/s]	Total head (m W.C.)					
a	b																	
BK 150 M	BK 150 T	1,1	1,5	2200	2140	31,5	9,5	6,2	3,6	H [m]	48,0	47,0	41,5	33,0	20,0	16		
BK 200 M	BK 200 T	1,5	2	2490	2450	40	11,5	7,6	4,3	H [m]	54,5	53,5	48,5	38,5	25,0	20		
BK 300 M	BK 300 T	2,2	3	2900	3060	50	13,5	9	5,2	H [m]	60,0	60,0	54,5	46,0	33,0	29,5		

a) ~ Single-phase 230 V

b) ~ Three-phase 230/400 V

TYPE		Nominal power		Input power [W]		Capacitor 450 V max	Input current [A]			Capacity								
Single-phase	Three-phase	kW	HP	a	b		[μF]	1~230V	3~230V	3~400V	Q [m ³ /h]	Q [l/s]	Total head (m W.C.)					
a	b																	
BK 400 M	BK 400 T	3	4	4470	4530	70	18	15,7	9	H [m]	66,0	65,0	61,5	58,0	50,5	42	37	
-	BK 550 T	4	5,5	-	6110	-	-	18,2	10,5	H [m]	79,5	79,0	78,0	72,0	65,0	56	50	
-	BK 750 T	5,5	7,5	-	7230	-	-	20	12	H [m]	89,0	87,0	83,0	78,0	71,5	62	58	45
-	BK 1000 T	7,5	10	-	9730	-	-	27,7	16	H [m]	110,0	107,0	102,0	96,0	90,0	83	80	66

a) ~ Single-phase 230 V

b) ~ Three-phase 230/400 V

TYPE		Nominal power		Input power [W]		Input current [A]			Capacity									
Three-phase		kW	HP			3~230V	3~400V		Q [m ³ /h]	Q [l/s]	Total head (m W.C.)							
BK 753 T		5,5	7,5		7080		19	11	H [m]	70,0	69,0	61,0	51,0	34,0	20			
BK 1003 T		7,5	10		10000		28,4	16,4	H [m]	85,0	86,5	81,0	70,0	52,0	40	25		
BK 1253 T		9,2	12,5		11380		32	19,5	H [m]	93,0	92,5	88,0	79,0	63,0	51	39		
BK 1503 T		11	15		13130		36,4	23	H [m]	105,0	106,0	100,0	90,0	73,0	61	50		

b) ~ Three-phase 230/400 V

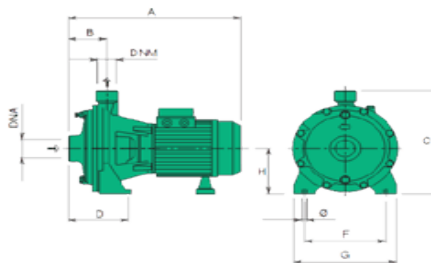

TYPE	DIMENSIONS [mm]								PACKING [mm]			WEIGHT [kg]		
	A	B	C	D	F	G	Ø	H	DNA	DNM	A		L	P
BK 100	325	71	227	100	140	180	9	97	1" G	1" G	255	210	335	15,7
BK 150	395	88	284	131	185	235	9,5	125	1" 1/2 G	1" G	325	265	430	26,5
BK 200	395	88	284	131	185	235	9,5	125	1" 1/2 G	1" G	325	265	430	28,5
BK 300	440	88	284	131	185	235	9,5	125	1" 1/2 G	1" G	290	275	470	32
BK 300 T	395	88	284	131	185	235	9,5	125	1" 1/2 G	1" G	325	265	430	28,5
BK 400 M	490	103,5	312,5	160	220	270	9,5	140	2" G	1" 1/4 G	380	330	530	50
BK 400	490	103,5	312,5	160	220	270	9,5	140	2" G	1" 1/4 G	380	330	530	45
BK 550	490	103,5	312,5	160	220	270	9,5	140	2" G	1" 1/4 G	380	330	530	46,5
BK 750	496	103,5	357,5	160	240	300	13	160	2" G	1" 1/4 G	450	370	650	61
BK 1000	496	103,5	357,5	160	240	300	13	160	2" G	1" 1/4 G	450	370	650	78,5
BK 753	540	117,5	345	179,5	230	295	13	160	2" G	1" 1/2 G	450	370	650	65
BK 1003	608	117,5	345	179,5	230	295	13	160	2" G	1" 1/2 G	450	370	650	81
BK 1253	608	117,5	345	179,5	230	295	13	160	2" G	1" 1/2 G	450	370	650	87
BK 1503	646	117,5	345	179,5	230	295	13	160	2" G	1" 1/2 G	451	430	720	95

min⁻¹ ~ 2900

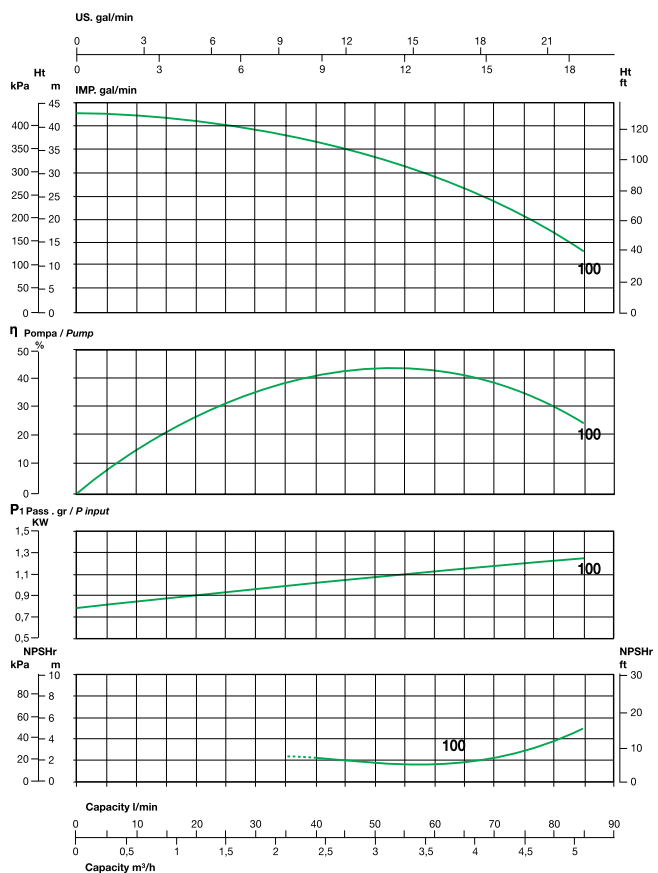

min⁻¹ ~ 2900

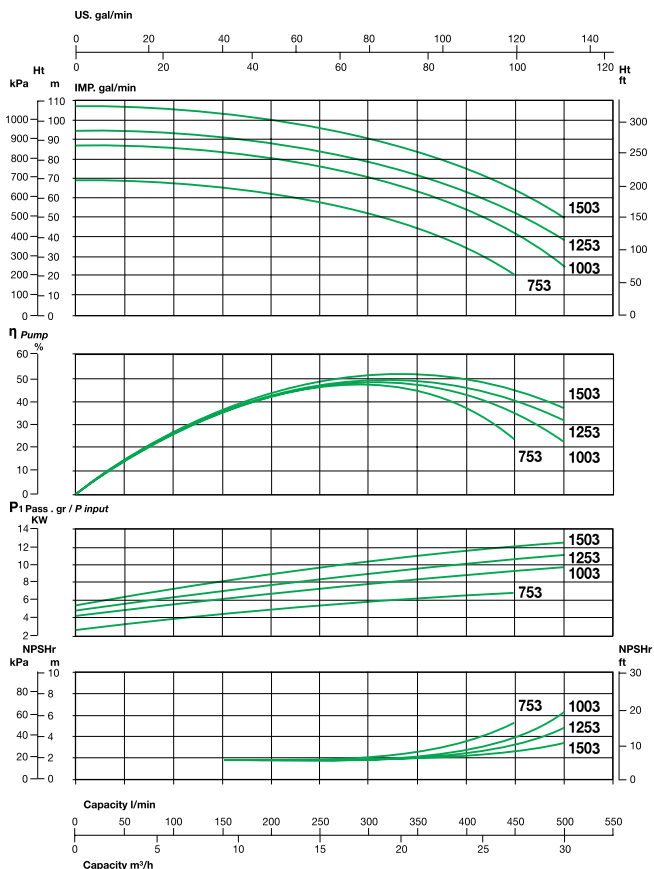
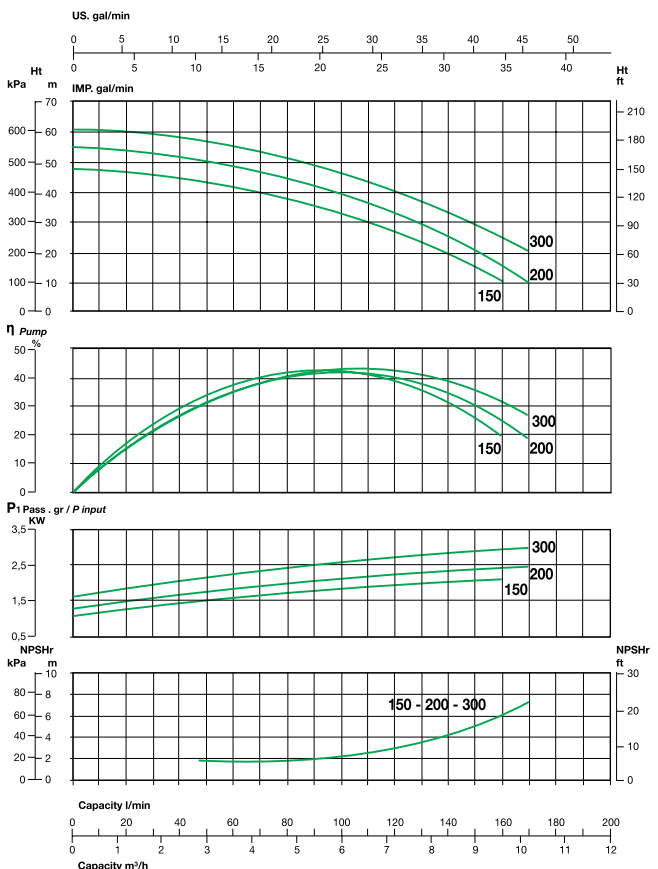
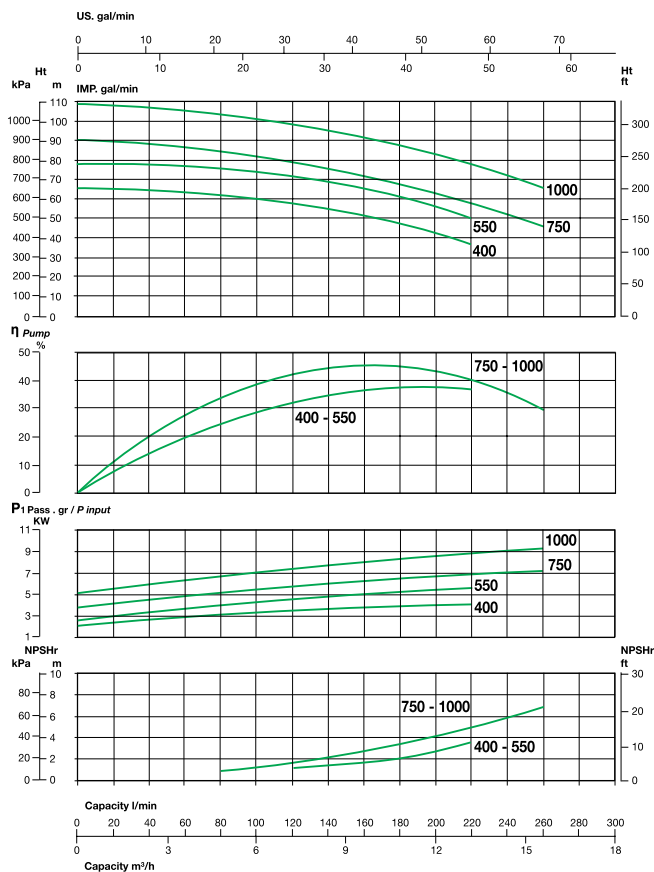

Sealand Electric Pumps South Africa

44 Agaat Str, Nirvana Industrial, Polokwane, Limpopo Province, South Africa, 0699



+27 87 150 2772



+27 86 647 3047



info@sealand.co.za



www.sealand.co.za